

© 2001 Advanced American Telephones. All rights reserved.
AT&T and the Globe Design are trademarks of AT&T Corp. licensed to Advanced American Telephones.
Printed in China. Issue 2AT&T 05/02

Visit us at www.telephones.att.com



**REVISED
5/7/02**



**USER'S MANUAL
Part 2**

Expansion Handset 2402

*Fold open this manual for information about this product's installation and operation. Please also read **Part 1 — Important Product Information.***



For Customer Service Or Product Information, Visit Our Website At www.telephones.att.com



BEFORE YOU BEGIN

About Handset Registration

- You must register this (and any other) handset with the base, following the directions in “REGISTER THE HANDSET.” This handset is compatible with telephone model 2462.
- The original handset that came with the base is automatically registered as Handset 1.
- Additional handsets will be assigned Handset 2, Handset 3, Handset 4, Handset 5, Handset 6, Handset 7, and Handset 8.
- Whenever you install a handset battery pack, the handset will display SEARCHING FOR BASE (if it’s registered) or ENTER BASE ID (if it’s not registered).

About Softkeys

- The handset softkeys are located below the screen display.
- Press the softkey below the operation displayed on the screen to select that operation. (For example, to enter the menu, press the center softkey).
- Press **OFF** (CLEAR) at any time to return to the previous screen.
- Press and hold **OFF** (CLEAR) to return to the idle screen.

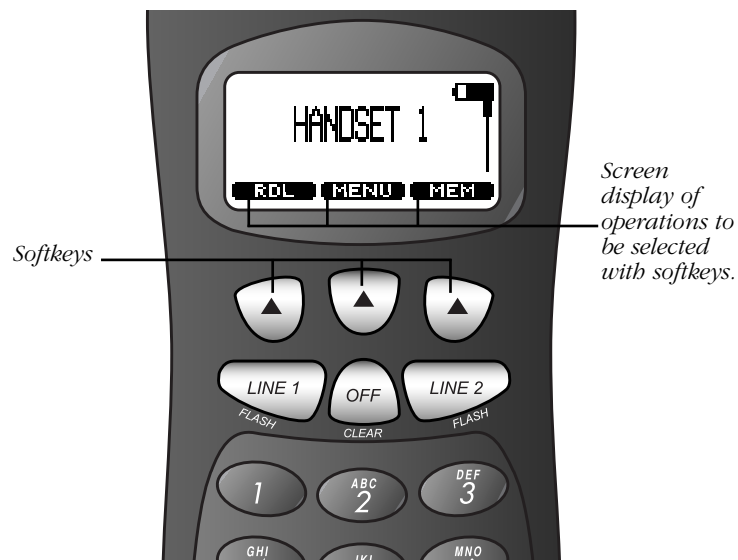

CHARGE THE BATTERY

1 Install the handset battery pack.

Use only the battery supplied with this handset or AT&T Accessory Battery Model 2401, SKU#91077.

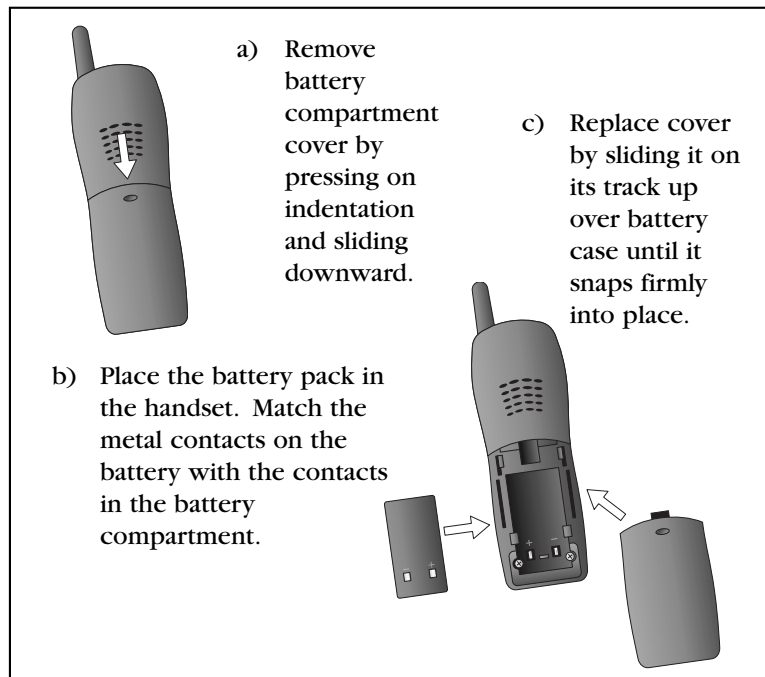

- When you install the battery pack the first time, the handset will display ENTER BASE ID.

2 Charge the handset battery.

- Place the handset in the remote charging stand (purchased separately). The CHARGING light goes on.
- Charge the battery at least 12 hours. After the first charge, the battery typically charges in only eight hours.

REGISTER THE HANDSET

- 1 Make sure to charge the handset battery pack at least 12 hours.
- 2 At the 2462 corded base, press **MENU**.
- 3 Use **▲** or **▼** to select **DISPLAY BASE-ID**.
- 4 Press **OK**. The base screen will display the 15-digit Base ID code for about 30 seconds, then return to the idle screen. Write down the Base ID code so you can enter it at the handset in **STEP 6** below.
- 5 At the cordless handset, use the softkey to select **REGISTER**.
- 6 Enter the 15-digit Base ID code.
- 7 Use the softkey to select **OK**. The screen displays **PLEASE WAIT!!**.
- 8 After about 45 seconds, the screen displays **FOUND BASE**. If the handset displays **BASE BUSY TRY LATER**, the base is in use.

**For complete operation instructions,
refer to the manual that came with
your original handset.**

INSTALLATION

Belt Clip

Attach the belt clip (*optional*).

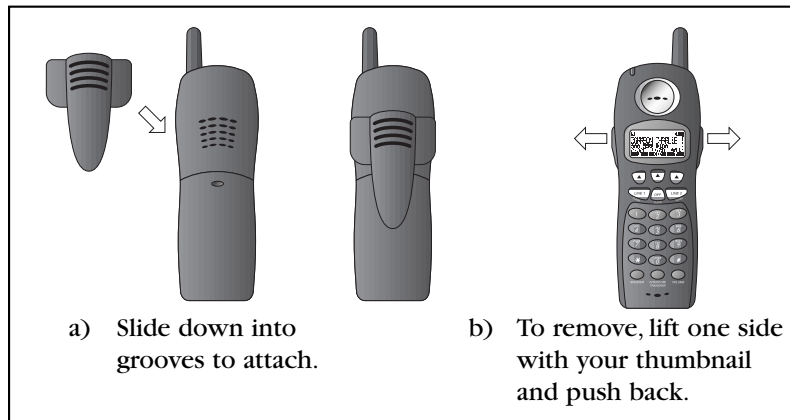

Headset

You can use this telephone hands-free when you install any industry standard 2.5 mm headset (purchased separately). For best results, use an AT&T 2.5 mm headset.

Plug the headset into the jack located on the left side of the handset (under the small rubber flap). Do not force the connection, but make sure the plug fits securely.



Battery Life

Battery life depends on how far the handset is from the base, and other environmental conditions.

NOTE: For optimum performance, charge your cordless handset in the handset charger every night.

Charge the Handset Battery Pack

- This battery should remain charged for up to five days. A fully charged battery provides an average talk time of about six to eight hours.
- The battery pack needs charging when:
 - The battery icon () flashes,
 - A warning tone sounds, or
 - The screen displays LOW BATTERY when idle.
- Place the handset in the handset charger so the CHARGING light goes on. The battery pack is typically charged in eight hours. For best results, the initial charge should be twelve hours.
- You can keep the battery fully charged by returning the handset to the handset charger after each use.
- If you repeatedly get a Low Battery indicator, even after eight hours of charging, the battery should be replaced. Use only AT&T Accessory Battery Model 2401, SKU# 91077.



CAUTION: Charge the battery provided with or identified for use with this product only in accordance with the instructions and limitations specified in the User's Manual, Part 1.